



ALTAIR



TEHNIICAL SPECIFICATIONS:

Yacht category: **Gulet**

Destination: **Croatia**

Base: **Split**

Yacht type: **Gulet**

Length overall: **24.50 m**

Beam: **7.50 m**

Draft: **2.20 m**

Guest Cabins: **6**

Guests number: **12**

Berths: **12**

Showers/toilets: **6**

Engine: **2xJohn Deere 235 KS**

Generator: **1x12kW Yanmar1x 32kW Sole Diesel**

Cruising Speed: **8 Kts**

Fuel tank: **7500 L**

Water tank: **17000 l**

Year built: **2008**

Superstructure: **steel**

Cabin floor: **wood**

Saloon floor: **teak**

Sun deck floor: **teak**

Crew cabins: **yes**



Altair

Gulet **ALTAIR** is a very nice 6 cabin gulet, a very special specimen since it is the only gulet that was completely built in Croatia and for the Croatian cruising especially. It has much of the typical gulet trademarks but it also has a unique combination of Croatian design.



Altair

LEISURE EQUIPMENT

Tender boat: 4.5 meters
Paddle board
Snorkelling equipment
Water ski
Donut ride/ringo ride
TV, DVD/CD player
WiFi
Board games, cards



Almar

ACCOMMODATION:

4 Double bed cabins (200×140 cm)

2 Twin cabins (200×90 cm).

Each of the cabins has wardrobe, 24 V/220 electricity, hair dryers, its own en suite bathroom, home like, with shampoo, toilet paper, soap, shower box.

Beach towels: 1 per person per week

Bathroom towels: 2 towels per person per week.

Additional beach or bathroom towels: on request

Bedding info: bed sheets are included in price.

Air-condition.



Altair

DECK

The design of the deck is the typical and well tested layout, with a sun bathing area in the front, and a dining area in the back, as well as a cushioned sofa.



Altair

Altair





Yacht



Attair



Alta







Altair



SALON AREAS

The salon is fully equipped with lounge and seating areas as well as the ship's bar. The bright corridors lead to the 6 cabins, of which 4 are double bed and 2 are twin bed cabins. The kitchen area is open plan so you can enjoy an appetizer while watching the diner getting prepared.

Galley & crew quarters: kitchen galley features all necessary equipment – including ovens, grill, refrigerators and deep freezers. The crew quarters are separate from the guests with private access at the bow.

Altair

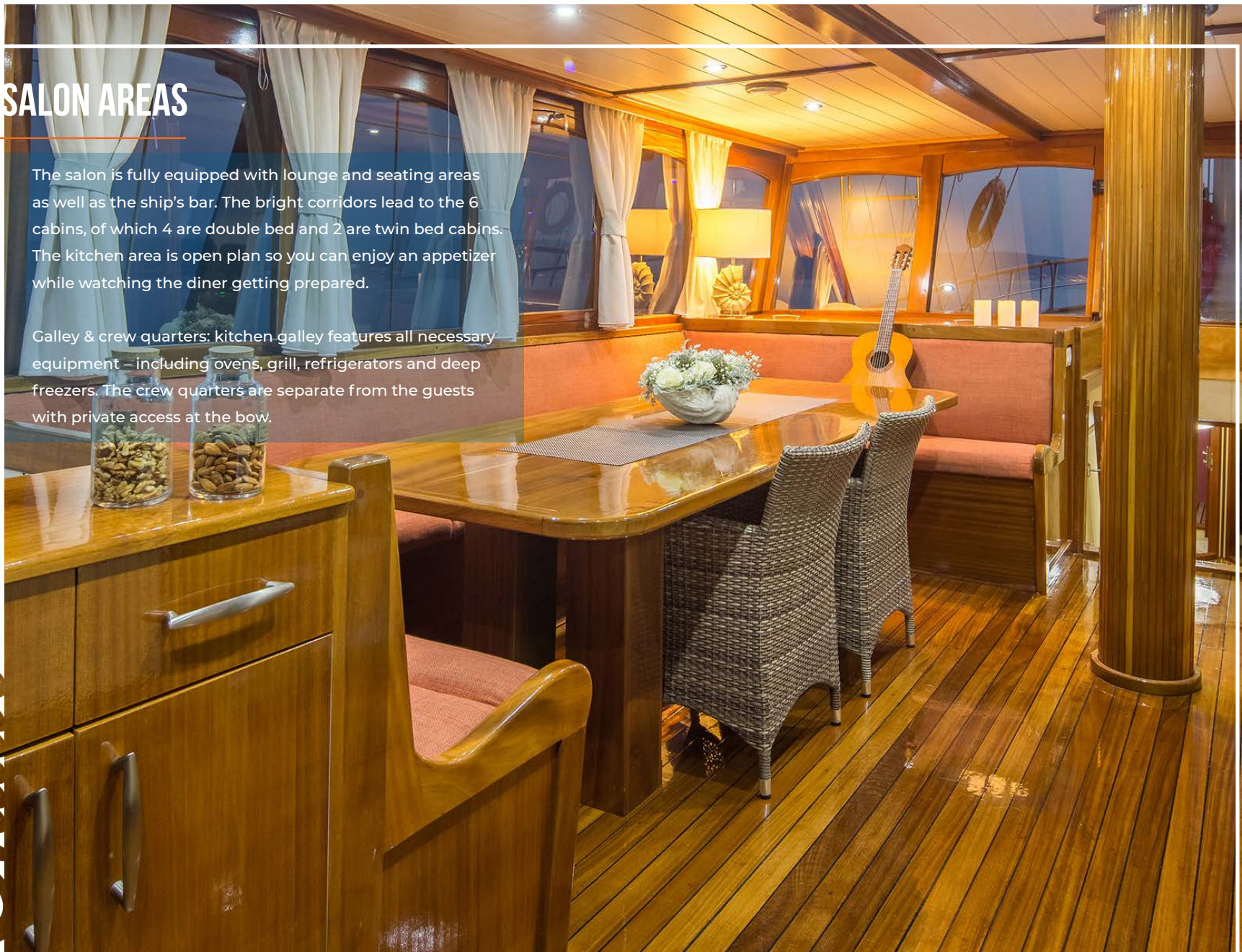

Altair



Altair



Altair



Altair



CREW



The crew is led by Captain Dare, an excellent and well experienced captain who takes pride in running an effective ship. Being very positive and outgoing, he enjoys making his guests happy. Like most of the best Captains in the area, he knows central Adriatic like the palm of his hand so best beaches and most attractive ports are ensured. The crew will be at your service, making sure you get everything you need for a stress-free cruising vacation.

Altair

LAYOUT

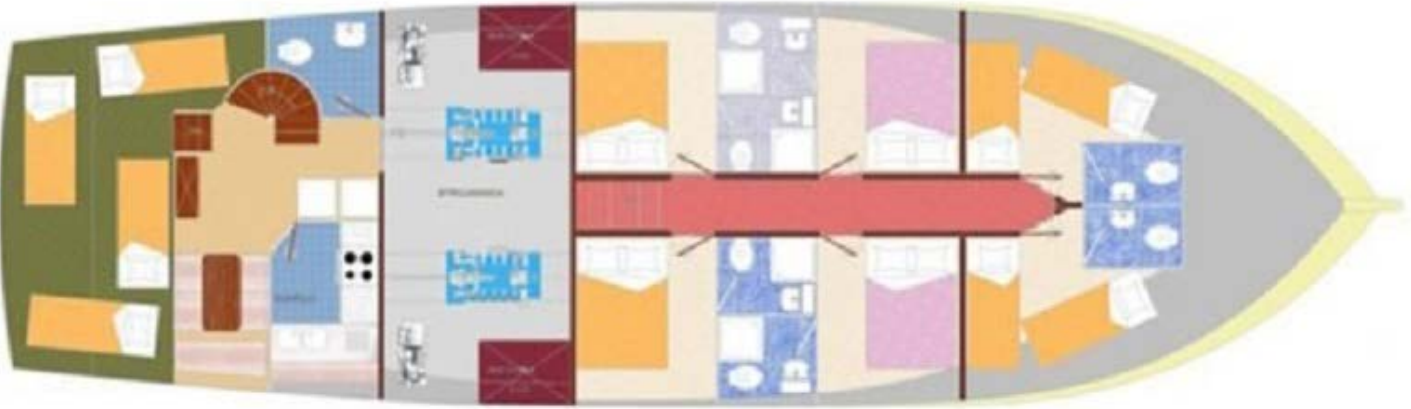



A L T A I R

Video Presentation